

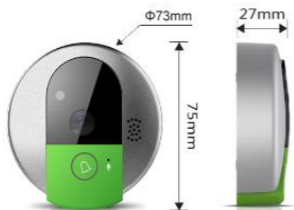

User manual



1. Product description;



| |
|-------------------------------------|
| Name:Doorcam |
| Resolution: 720P |
| Night vision distance: 5m |
| Rated voltage: DC5V \pm 0.3V / 2A |
| Power consumption: 3.2W |

2. Product installation;

A. Wall mounting;



Doorcam



Metal hanging plate



Plastic hanging plate



Screws

:

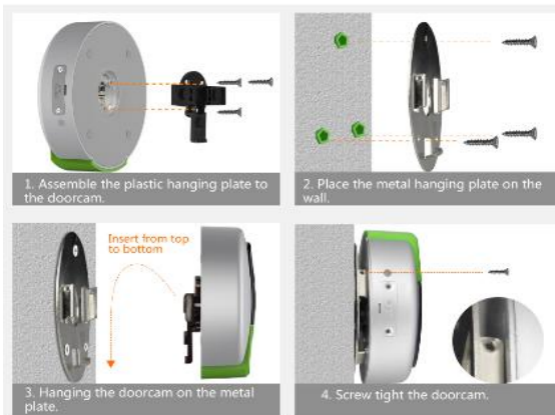

B. Peephole installation;



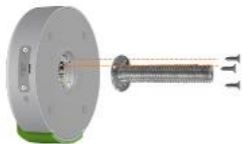

1. Assemble the doorcam with the screw stick.

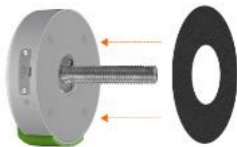

2. Stick the EVA foam on the doorcam.



3. Place the assembled doorcam on the door



4. Put the metal hanging plate on the screw stick.

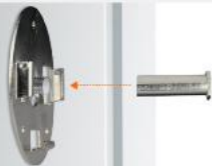

5. Screw tight.



6. Cover the lid.

3. Software download

- a. Go to [<http://www.eyecloud.so>] download ;
- b. Scan below QR code to download ;



4. Register an account

Register an EyeCloud account, Open Android/iOS APP, click register, and enter the user name, password to complete registration.

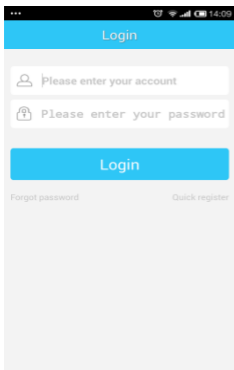

The screenshot shows the 'Login' screen of the EyeCloud app. At the top, there is a blue header with the word 'Login' in white. Below the header, there are two input fields: the first is labeled 'Please enter your account' and the second is labeled 'Please enter your password'. Below these fields is a large blue button with the text 'Login'. At the bottom of the screen, there are two links: 'Forgot password' on the left and 'Quick register' on the right. The status bar at the top shows the time as 14:09 and various system icons.

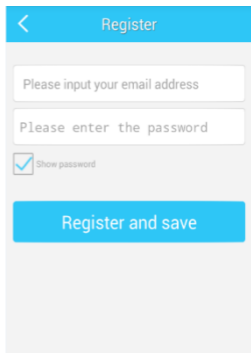

The screenshot shows the 'Register' screen of the EyeCloud app. At the top, there is a blue header with a back arrow on the left and the word 'Register' in white. Below the header, there are two input fields: the first is labeled 'Please input your email address' and the second is labeled 'Please enter the password'. Below these fields is a checkbox labeled 'Show password' which is checked. At the bottom of the screen, there is a large blue button with the text 'Register and save'.

5. Add camera

Click“+”, enter device management interface. There are three options to add camera:

- ① One key WiFi Setup: (**Place the smartphone microphone near the camera, follow the voice instruction to bind camera**)
- ② Search LAN: find the doorcam in the same WiFi network as the mobile phone.
- ③ Manually input: Please input camera 15digital UID, default password is **888888**;

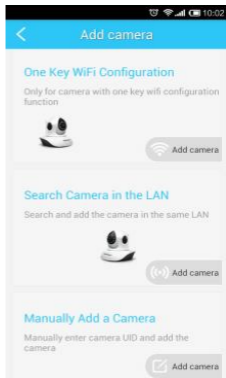

6. Video interface description

| | |
|--|-----------------|
| Horizontal cruise | Vertical cruise |
| Preset position | Full screen |
| Listen unable | Enable listen |
| Talk unable | Enable talk |
| Snapshot, can browse picture in history. | |
| Recording, can view video in history. | |

7. Device management

1. Delete camera: slide left to delete camera.

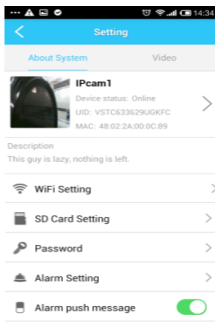
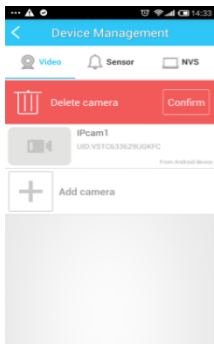

2. Click camera list to setup WiFi, storage, Password, Alarm, SMS, and firmware upgrade ect ;
 3. Storage status: can view SD storage, format (need to format SD card before use), and enable recording function.
- Note: SD card cannot record if the SD card cannot show properly the remaining storage

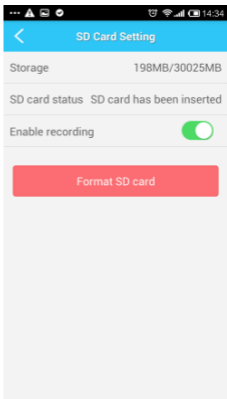
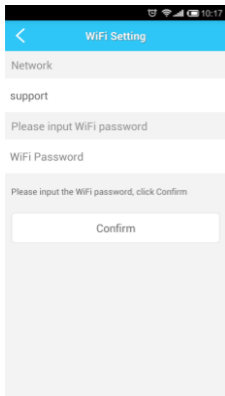

8. Message push

1. Enable push notification; Security center—message center—choose inform (the client inform, email inform, phone inform, WeChat in form) —turn on/off ;

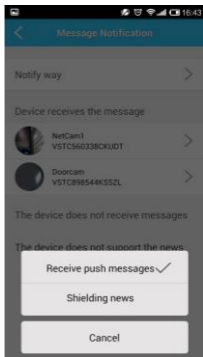
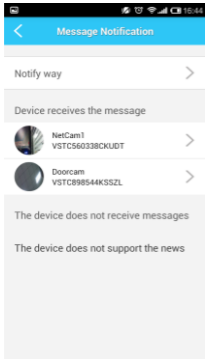

2. Receive push notification: If enable this function, when someone press the doorbell, your phone will receive notification, you can choose ignore or view the real time video.

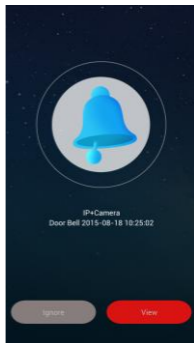

9. Information center

Information center divide into alarm message and system message.

1. Alarm message means the doorcam push notification, shows the time and status, click to view the real time picture.
2. System message : remind the upgraded firmware information ect.

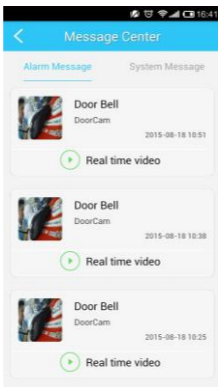

10. Security center

Security centre include weak password remind, phone bundle, email verification, gesture password and push notification; click inspection will start security check.

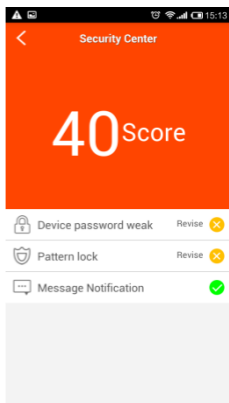
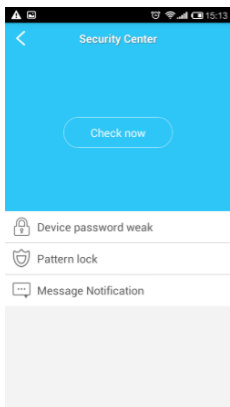

Note :As the picture shows: if the account is not safe ,you should bind operation in each option of the device.